



2000 I-30 E
Greenville, TX 75402

Friday, May 13, 2022

Office of Hopkins County Judge
PO Box 288
Sulphur Springs TX 75483

Farmers Electric Cooperative Member: MICHAEL SPADARO
Service Order Number: 2021123380

Greetings:

Farmers Electric Cooperative, Inc. is requesting permission to construct electrical power distribution facilities which will cross County Road 3351 which is located 1085 ft northwest of CR 2310 in Hopkins County, Texas.

Site location map and construction sketches are enclosed. The construction sketch details the proposed work. All road crossings will have a minimum vertical clearance of 22 feet.

If you have any questions, please contact me at any time.

Sincerely,

Tamara Williams
Project Coordinator
twilliams@farmersselectric.coop
Phone 903-513-2903

Submitted by Brandon Darrow
bdarrow@farmersselectric.coop
Field Engineering Coordinator

Enclosures

County Approval Section:
Approved: Denied:
Authorized Signature: Wanda Bentley Date: 5-16-22

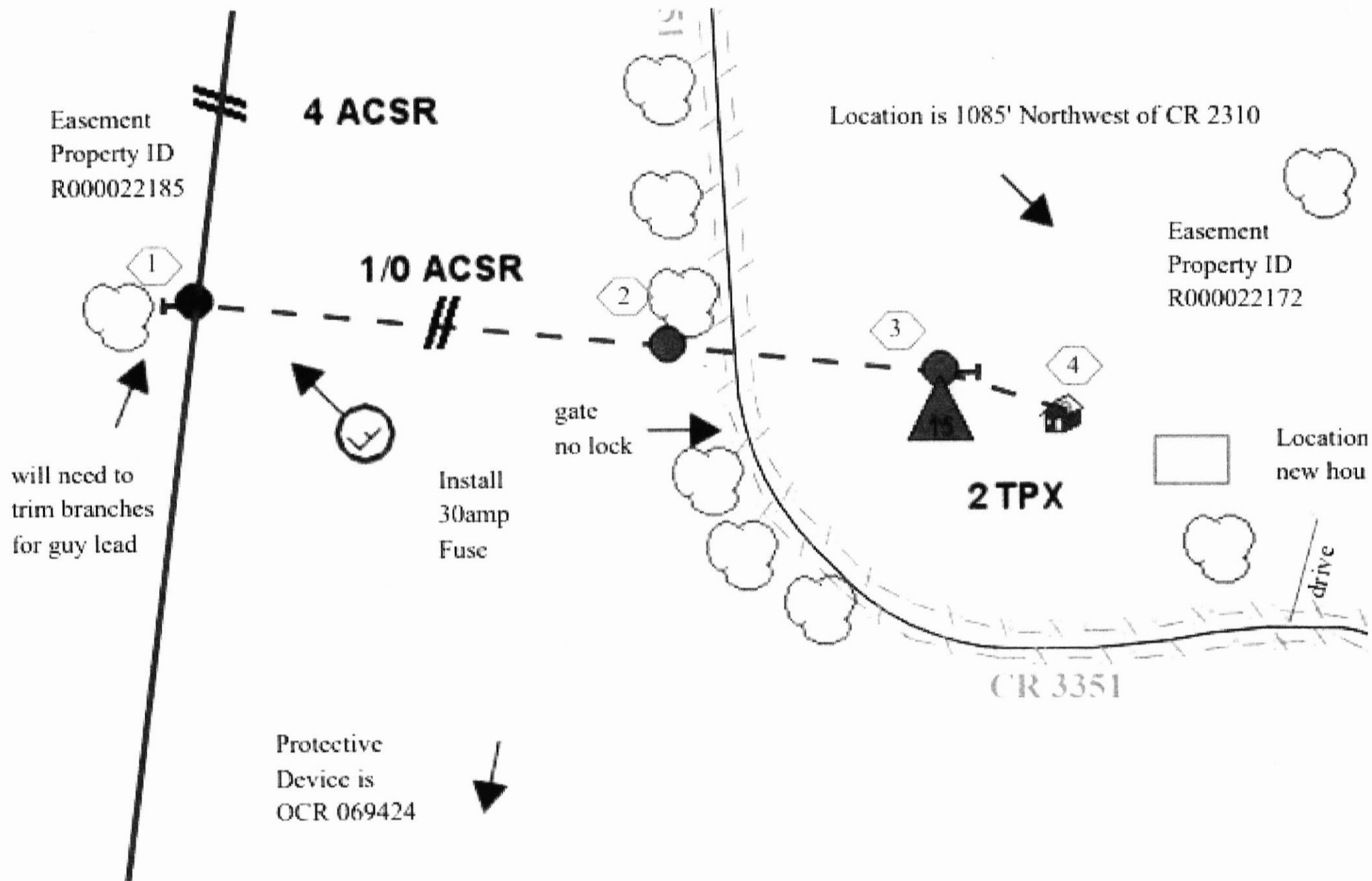



County Road 3351

Michael Spadaro
Service Order#
2021123380
Set service pole
and cross CR 3351



County Road 3351